

Deaf Studies Links

A Newsletter for Resource Teachers of the Deaf in the Central and Southern Regions of New Zealand

Issue 1

AUGUST 2010

Severe hearing loss hinders recognition of emotions of others.

Hearing impaired children and adolescents have difficulty recognizing and understanding the reaction of others in certain situations.

An Australian study involving 163 children aged between 6 and 18 years found that children with hearing loss were up to 50 percent less able than their hearing peers to interpret the feelings of other people.

Understanding people whose emotional response was different than expected presented the greatest challenge for the hearing impaired children. In this respect hearing impaired children aged 6 to 11 years were 50 percent below the performance of their hearing peers.

Hearing impaired youngsters generally have trouble judging the expected emotional response of others to a certain event. The study found their ability in this respect to be 30 percent below that of normal hearing youngsters. Another test indicated a 25 percent deficiency among the hearing impaired children in rapid and accurate interpretation of the meaning of somebody else's facial expressions.

The researchers behind the study consider the lack of emotion recognition among the hearing impaired children to be a significant problem. In most instances, however targeted training programmes would help correct this condition and in most cases improve the hearing impaired youngsters' social skills.

Sources: *Emotion Recognition/Understanding Ability in Hearing or Vision-impaired Children: Do Sounds, Sights, or Words Make the Difference?*, *Journal of Child Psychology and Psychiatry*, No. 4 2004.



New Teaching Resource Emotions & Feelings

A set of cards with faces showing a variety of emotions/feelings.

On the back of the card are two or three pictures with sentences that depict the emotion/feeling. Use these to generate discussion and link to the child's own experience.

Please email me with your feedback. I'd also like to know other emotions/feelings that are not in the pack and that you would find useful to include.

aboone@vanasch.school.nz

Here is a list of those already developed:

angry	bored
cautious	cold
confident	content
curious	determined
disappointed	dismayed
embarrassed	frightened
frustrated	hurt
joyful	kind
lonely	miserable
worried	

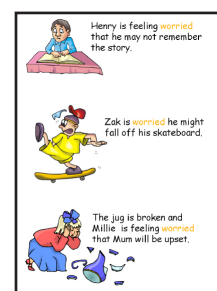
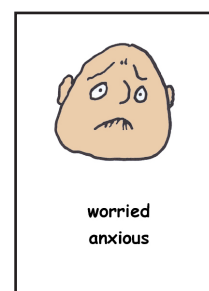
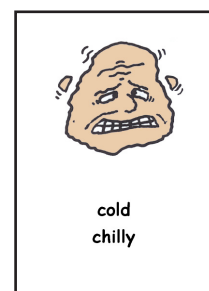

For more informative articles go to <http://www.hear-it.org/page.dsp?page=3630>

NEW RESOURCES

You may already have received some of these resources, the others will be arriving at your host schools soon.

CROSSWORDS

VEHICLES - Cat No. 442

ANIMALS - Cat No. 446

FOOD - Cat No. 447

\$5.00 EACH

These crosswords are designed to reinforce the student's development of the vocabulary associated with the categories. The set includes cards, game board and fingerspelling sheet.

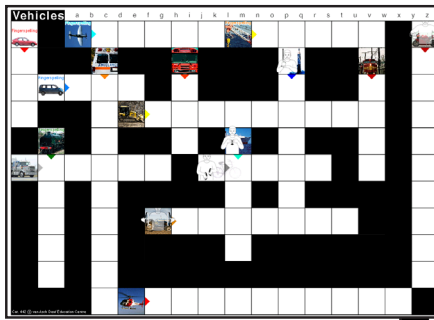

CLASSROOM SITUATIONS COMMUNICATION

\$1.00 Cat no. 448

This A4 sheet compares preferences, from deaf and hearing perspectives, in gaining attention, lighting and seating in the classroom.

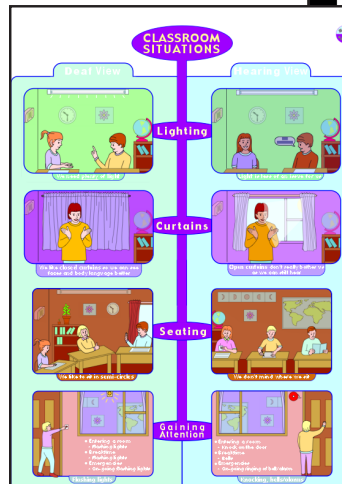

SNAKES AND LADDERS

\$10.00 Cat no. 449

This popular game has been adapted to reinforce good communication skills in the classroom. Three A3 laminated board games (dice not included). The blank board game is for you to write your own targets linked to the specific learning outcomes for the area of focus with your student.

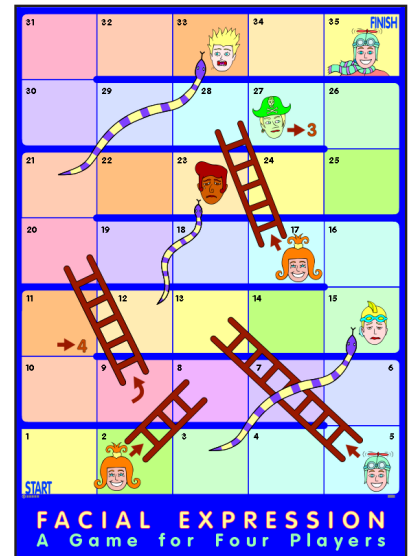

NZSL HANDSHAPE DICE

\$1.00 Cat no. 450

The NZSL Handshape dice is an excellent way of getting both oral and signing kids to think about how they use their hands. You can make the task as difficult or as complex as you like. Try and get their classmates in on the game too! The idea is to just throw the dice and to think of a gesture or sign that is based on the handshape that appears. For example, the 'OK' handshape could be used as the gesture for 'No problem' or to represent the shape of a tube or the sign for 'INTERPRETER'.

You can also use this as a language building game, such as, I was walking down the street and I saw a..... (throw the dice and an 'INDEX FINGER' handshape comes up)a caterpillar crawling up a tree.

The possibilities are endless! Also included is a standard 1 to 6 number game dice. Templates printed on firm card.

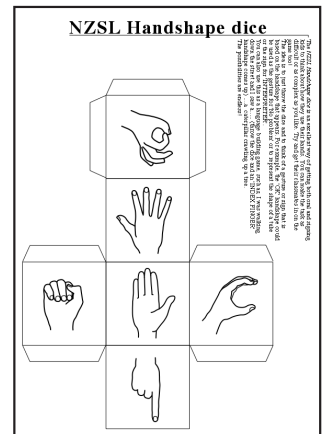

WEBSITE - Deaf Nation

No Barriers with Joel Barish

deafnation.com

Video clips of Joel talking about the different cultures in the variety of countries he visits on his travels.

